



Power-Flo LX™

SP1580 PUMP SERIES REPLACEMENT PARTS

Pumps

Parts for Pump Models: SP1575LX, SP1580, SP1580X15, SP1520UN, EP1500LX and SP1680 Series

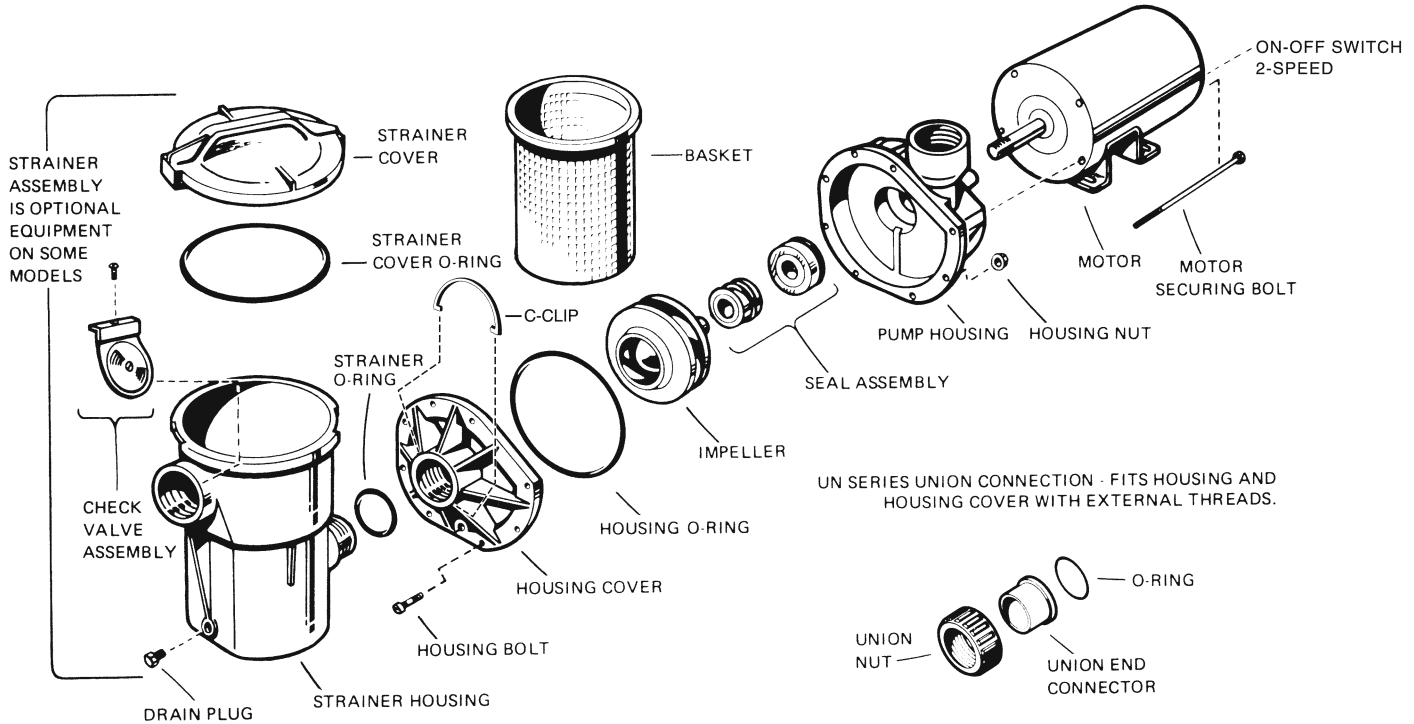

Part No.	Description	Ctn. Qty.
SPX1580AAP	Pump Housing	4
SPX1580BP	Housing Cover	2
SPX1500KA	Seal Assembly with Cup	10
SPX1580Z1	Housing O-Ring	10
SPX1500N2	Housing Bolt, No. 10-24 Hex. Head	20
SPX1500Y2	Housing Nut, No. 10-24 Hex.	20
SPX1500F	Impeller (refer to part number on original equipment)	10
SPX1500L	Impeller (refer to part number on original equipment)	25
SPX1500CAP	Strainer Housing with Basket	1
SPX1500D2A	Strainer Cover with O-Ring	10
SPX1500P	Strainer Cover O-Ring	10
SPX1250RA	Strainer Basket (1992 and Prior)	10
SPX1500LX	Strainer Basket – Large, 4 1/2" x 7"	10
SPX1500RA	Check Valve Assembly (1990 and Prior)	10
SPX1500W	Strainer O-Ring	10
SPX1700FG	Drain Plug with Gasket	10
SPX1500X1	Shim for vertical discharge (1999 and Prior)	10
SPX1515C	Strainer Housing C-Clip (2000-2003)	10
SPX1515CN	Strainer Housing C-Clip (2004-)	10
SPXHKIT12	H-KIT Quick Pump Repair for Power-Flo (Includes SPX1500KA, SPX1580Z1, SPX1500P, SPX1500W, SPX1500H, SPX1705Z1 and Jack's Lube)	10

SP1520UN LX Parts same as SP1580 Series except as listed below:

SPX1580AAT	Pump Housing with External Thread	4
SPX1520BT	Housing Cover with External Thread, 1, 1 1/2 and 2 H.P.	2
SPX1500LH	1 H.P. Hi-Performance Impeller	10
SPX1580CH	1 1/2 H.P. Hi-Performance Impeller	10
SPX1525CH	2 H.P. Hi-Performance Impeller	10
SPX3005R	Impeller Ring – for Hi-Performance Impellers	1

SP1680 Series Parts same as SP1580 except as listed below*:

SPX1680GA*	Basket	10
------------	--------	----

NOTES: *Limited Quantity Available.

Parts for Power-Flo Pump Motors are listed on page 135.